



Hillsborough Area Regional Transit Authority

New North Transportation Alliance
May 7, 2014

Current Services in New Tampa Corridor

- HART Route 51X – Wesley Chapel to Downtown Tampa
- 2 south bound trips in the AM
- 2 north bound stops in the PM
- 3 park and ride locations
- Ridership = 70 per day or 17,500 per year



Current Route – 51X

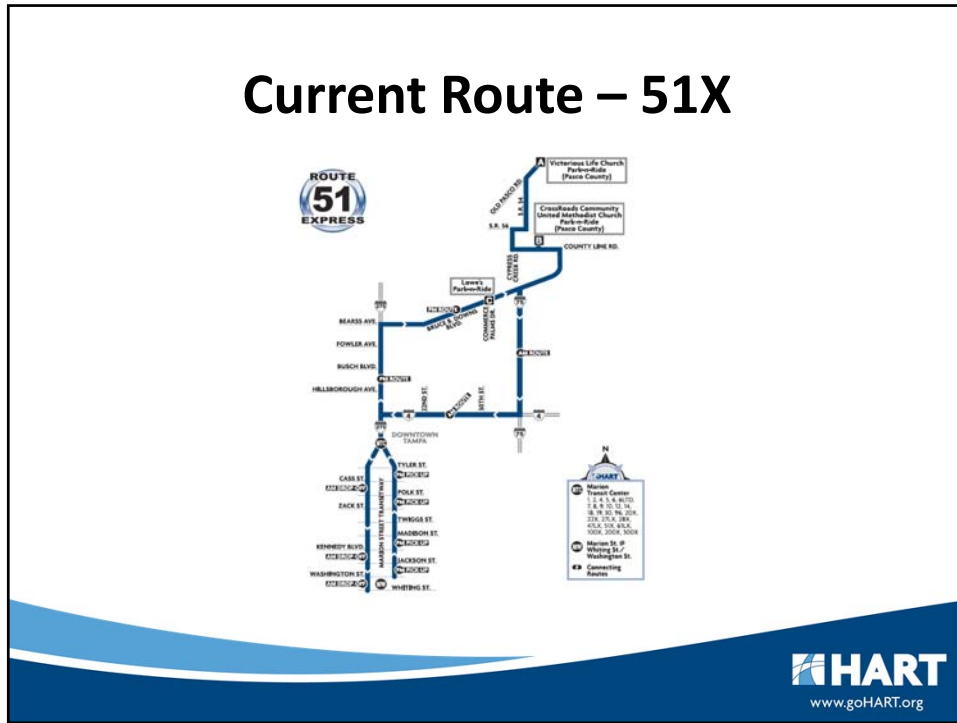

PROPOSAL FOR ROUTE 51X

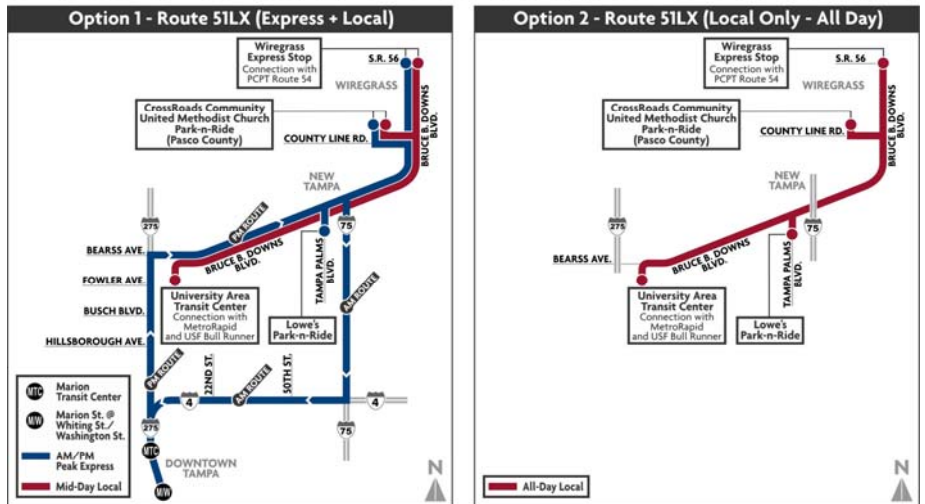

For more information call (813) 254-4278 or visit www.goHART.org



51X Options

- Option 1
 - Retain downtown express AM and PM peaks
 - Local midday service between UATC and Wiregrass area
 - Bus stops at strategic points on BBD
 - 'Kiss' and Ride areas
 - Connect to PCPT Route 54 in Wiregrass area
 - Hourly service approximately 8 AM – 4 PM
 - Re-designate as 51LX

51X Options

- Option 2
 - Eliminate direct downtown service
 - Patrons for downtown transferred to MetroRapid or 6LTD
 - Local only service between UATC and Wiregrass area
 - Bus stops at strategic points on BBD
 - 'Kiss' and Ride areas
 - Connect to PCPT Route 54 in Wiregrass area
 - Hourly service approximately 6 AM – 8 PM
 - Re-designate as 51LX

Future Plans

- FY 2016
 - Two Flex routes in New Tampa
 - North Route
 - South Route
 - Connection or Joint Operation with PCPT
 - 30 minute service ?
 - Acceptance of PCPT and HART fare media
 - Single branding?
 - Start in FY 20??



Next Step

- Three Open Houses
 - May 20
 - June 17
 - June ?
- Public Hearing
 - July 8



Questions?

Contact:

**Steve Feigenbaum, HART SR. Manager of
Service Planning**

feigenbaums@gohart.org

813-384-6559

